

NOTE
CENTER LINE OF TRACK
IS DIVISION LINE BETWEEN
PARCELS FROM PARCEL 5
TO PARCEL 23

MILW
SOLD TO B.N. INC
BY TRUSTEE DEED
OF OCT 24, 1984

Special Assmts
AFF 16504 (1924) Drainage Ditch - Deed in Dist #20

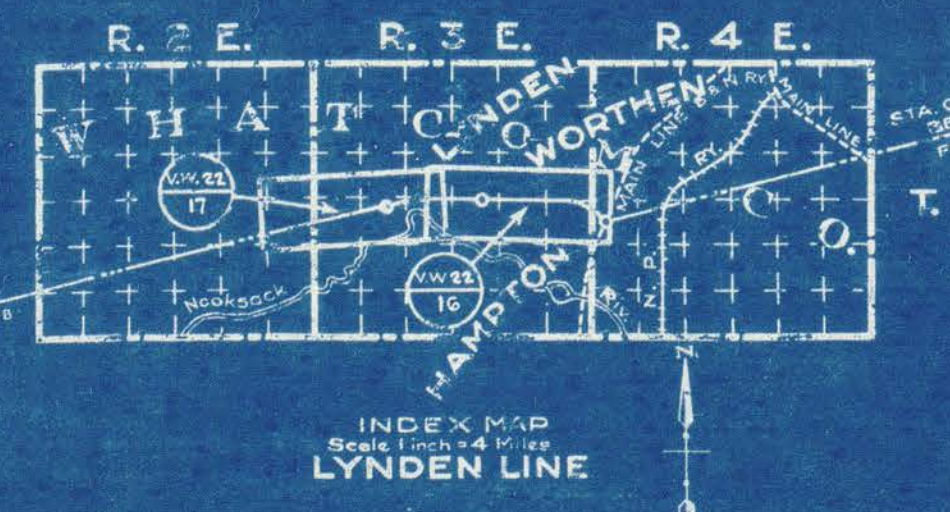

PARCEL NUMBER	GRANTOR	GRANTEE	INSTRUMENT	DATE	RECORD	CUSTODIAN'S NO.	REMARKS
1	W. R. Moultray & Wife	R.P.A.S.C.P.R.Co.	R.W.D.	3-17-05	73,476, Apr. 18, 1905	7226	
2	David Wright & Wife	R.P.A.S.C.P.R.Co.	R.W.D.	6-15-04	73,477, June 30, 1904	7227	
3	Elif Johnson & Wife	R.P.A.S.C.P.R.Co.	R.W.D.	6-15-03	73,245, Feb. 25, 1904	6773	
4	Jacob Patterson & Wife	R.P.A.S.C.P.R.Co.	C.O.D.	6-18-03	73,246, Feb. 25, 1904	6774	
5	Elif Johnson & Wife	R.P.A.S.C.P.R.Co.	R.W.D.	6-18-03	73,245, Feb. 25, 1904	6773	
6	Jacob Patterson & Wife	R.P.A.S.C.P.R.Co.	C.O.D.	6-18-03	73,246, Feb. 25, 1904	6774	
7	B. & N. Ry. Co.	County of Whatcom	Agreement	12-3-34	73,245, Feb. 25, 1904	6773	60' Public Highway across R.W.
8	Elif Johnson & Wife	R.P.A.S.C.P.R.Co.	R.W.D.	6-18-03	73,245, Feb. 25, 1904	6773	
9	Jacob Patterson & Wife	R.P.A.S.C.P.R.Co.	C.O.D.	6-18-03	73,246, Feb. 25, 1904	6774	
10	Mary H. Shepherd, Executrix	R.P.A.S.C.P.R.Co.	R.W.D.	10-12-03	73,245, Feb. 25, 1904	6773	
11	The Northern Counties Investment Trust, Ltd.	R.P.A.S.C.P.R.Co.	R.W.D.	5-12-03	73,46, Jan. 2, 1904	6775	
12	Mary E. Peasemoff	R.P.A.S.C.P.R.Co.	R.W.D.	10-1-04	73,78, Oct. 10, 1904	6776	
13	T.H. DeSawa & Wife	R.P.A.S.C.P.R.Co.	R.W.D.	5-16-03	73,245, Feb. 25, 1904	6773	
14	Christopher J. Spenser & Wife	R.P.A.S.C.P.R.Co.	R.W.D.	5-6-03	73,246, Feb. 25, 1904	6774	
15	Herbert F. Crabtree	R.P.A.S.C.P.R.Co.	R.W.D.	5-6-03	73,245, Feb. 25, 1904	6773	
16	Continental American Mortg. & Trust Co., Ltd.	R.P.A.S.C.P.R.Co.	R.W.D.	6-25-03	73,45, Jan. 2, 1904	6775	
17	M. E. Peasemoff	R.P.A.S.C.P.R.Co.	R.W.D.	10-1-04	73,78, Oct. 10, 1904	6776	
18	T.H. DeSawa & Wife	R.P.A.S.C.P.R.Co.	R.W.D.	5-16-03	73,245, Feb. 25, 1904	6773	
19	C.J. Spenser & Wife	R.P.A.S.C.P.R.Co.	R.W.D.	5-6-03	73,246, Feb. 25, 1904	6774	
20	Herbert F. Crabtree	R.P.A.S.C.P.R.Co.	R.W.D.	5-6-03	73,245, Feb. 25, 1904	6773	
21	Continental American Mortg. & Trust Co., Ltd.	R.P.A.S.C.P.R.Co.	R.W.D.	6-25-03	73,45, Jan. 2, 1904	6775	
22	B. & N. Ry. Co.	County of Whatcom	Agreement	11-4-13	69,43, Aug. 24, 1903	6761	40' Public Highway across R.W.
23	Victor H. Purdie	R.P.A.S.C.P.R.Co.	R.W.D.	6-15-03	73,245, Feb. 25, 1904	6773	
24	James Purse & Wife	R.P.A.S.C.P.R.Co.	R.W.D.	6-15-03	73,246, Feb. 25, 1904	6774	
25	Ray Hock-Sab-Puton	R.P.A.S.C.P.R.Co.	R.W.D.	5-6-03	73,245, Feb. 25, 1904	6773	
26	S.W. Wortman & J. J. Stork	R.P.A.S.C.P.R.Co.	R.W.D.	5-6-03	73,246, Feb. 25, 1904	6774	
27	S.W. Wortman & J. J. Stork	R.P.A.S.C.P.R.Co.	R.W.D.	8-5-03	68,124, Sept. 4, 1903	6574	
28	Martin Moser & Wife	R.P.A.S.C.P.R.Co.	R.W.D.	6-15-03	73,244, Feb. 25, 1904	6772	
29	Emmy A. Van Os & Wife	R.P.A.S.C.P.R.Co.	C.O.D.	2-8-11	119,77, Feb. 11, 1911	6782	
30	Thomas A. Moorman	R.P.A.S.C.P.R.Co.	R.W.D.	5-21-03	73,246, Feb. 25, 1904	6774	
31	Sliah H. Brackley	R.P.A.S.C.P.R.Co.	R.W.D.	5-6-03	73,241, Feb. 25, 1904	6771	
32	O. H. Bacon et al	R.P.A.S.C.P.R.Co.	C.O.D.	6-17-05	80,432, Sept. 20, 1905	6792	
33	Henry F. Jones	R.P.A.S.C.P.R.Co.	R.W.D.	9-12-03	73,431, Apr. 1, 1903	6817	
34	State of Washington	R.P.A.S.C.P.R.Co.	Grant & Filing Map	3-1-04	73,241, Feb. 25, 1904	6771	
35	Henry F. Jones & Wife	R.P.A.S.C.P.R.Co.	R.W.D.	9-17-03	73,423, Apr. 1, 1903	6817	

Sheet No. 16 of 17 sheets of C.M. & St. P. Ry. Co. Main Line
From survey station 21+00 to survey station 21+20

A.E. Lodge
Valuation Engineer

RIGHT OF WAY AND TRACK MAP
CHICAGO, MILWAUKEE & ST. PAUL RY. CO.
OPERATED BY THE
CHICAGO, MILWAUKEE & ST. PAUL RY. CO.
BELLINGHAM DIVISION MAIN LINE
STATION 0+00 TO STATION 21+20
SCALE 1" = 400 FT. JUNE 30 1918
OFFICE OF VALUATION ENGINEER
CHICAGO, ILLINOIS

WHATCOM 16