

NON OPERATING
PER LETTER OF
AUG. 17, 1979

SELLECK
KING COUNTY,
WASH.

PARCEL NUMBER	GRANTOR	GRANTEE	INSTRUMENT	DATE	RECORD	CUSTOMER'S NO.	REMARKS
1	Seattle Southwestern Ry. Co.	Chicago, Milwaukee & Puget Sound Ry. Co.	Deed	2-13-12	#16,347, June 6, 1912	B-155	CM&STP Ry. Co. paid \$20000.00 for 2 miles of railroad extending from Bagley Jct. to point of connection with Emuclaw Branch.
2	Seattle Southwestern Ry. Co.	CM&STP Ry. Co.	Deed	2-13-12	#16,347, June 6, 1912	B-155	
3	Pacific States Lumber Co.	CM&STP Ry. Co.	W.D.	2-14-10	758,154, Feb. 14, 1910	9861	
4	Pacific States Lumber Co.	CM&STP Ry. Co.	Snow Easement in W.D.	2-14-10	758,154, Feb. 14, 1910	9861	
5	Pacific States Lumber Co.	CM&STP Ry. Co.	Snow Easement in W.D.	2-14-10	758,154, Feb. 14, 1910	9861	
6	John Lavender & Wife	CM&STP Ry. Co. of Wash.	W.D.	5-2-09	778, 50, Oct. 15, 1909	9862	
7	John Lavender & Wife	CM&STP Ry. Co. of Wash.	Snow Easement in W.D.	5-2-09	778, 50, Oct. 15, 1909	9862	
8	John Lavender & Wife	CM&STP Ry. Co. of Wash.	Snow Easement in W.D.	5-2-09	778, 50, Oct. 15, 1909	9862	
9	Pacific States Lumber Co.	CM&STP Ry. Co.	W.D.	2-14-10	758,154, Feb. 14, 1910	9861	
10	Pacific States Lumber Co.	CM&STP Ry. Co.	Snow Easement in W.D.	2-14-10	758,154, Feb. 14, 1910	9861	
11	Pacific States Lumber Co.	CM&STP Ry. Co.	Snow Easement in W.D.	2-14-10	758,154, Feb. 14, 1910	9861	
12	D.W. Walters	CM&STP Ry. Co.	W.D.	5-2-09	775, 217, Oct. 15, 1909	9865	
13	Northwestern Improvement Co.	CM&STP Ry. Co.	W.D.	1-5-10	758,154, Feb. 14, 1910	8524	
14	Northwestern Pacific Ry. Co.	CM&STP Ry. Co.	W.D.	4-10-20	1110, 321, July 7, 1920	1581	AFE 630
15	City of Seattle	CM&STP Ry. Co. & NP Ry. Co.	Ordinance	9-12-23		9741	AFE 36994

AFE 38994
TRANSFERRED TO 705



35' N. 75' E.
35' N. 75' E.

Reclassified non operating
April 11, 1948
see non operating property report
for year ended Dec. 31, 1957
(make abated entries)

Agree re classified as operating
beginning with year 1974

CM&STP & NP
Tracks to be used
jointly with W.P.R.Y.

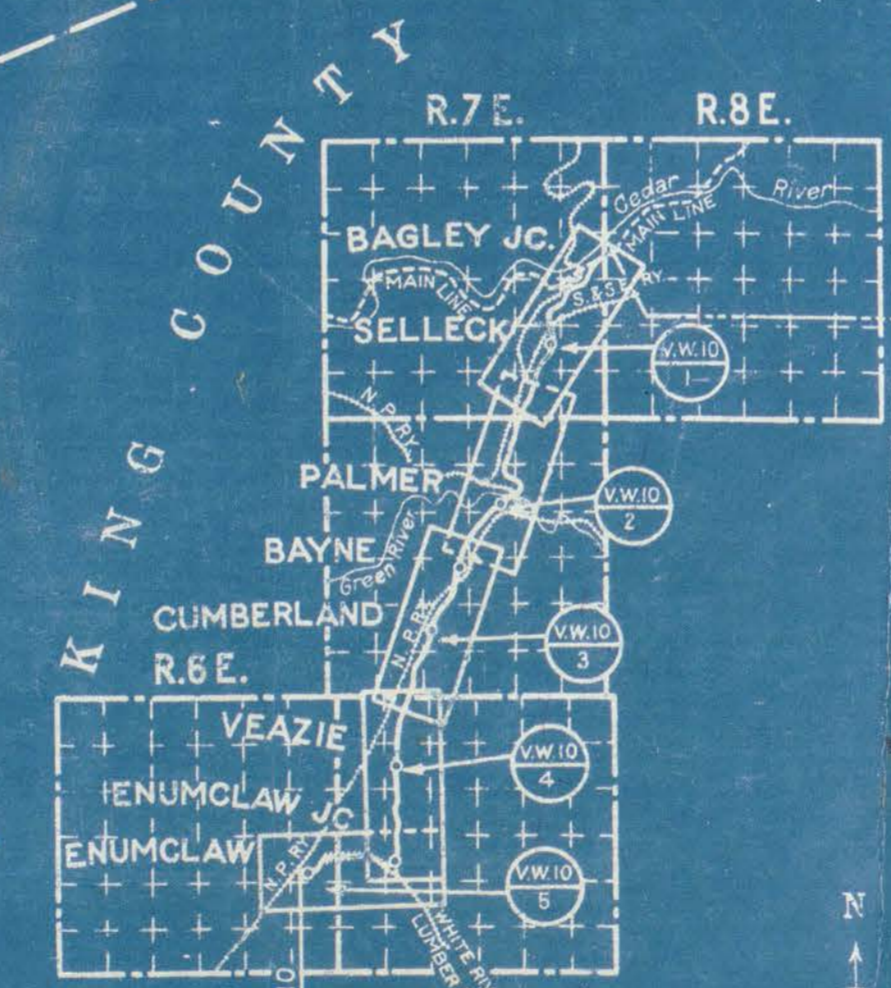

INDEX MAP
COAST DIVISION
ENUMCLAW LINE
SCALE: 1" = 1 MILE.

State of Illinois
County of Cook

I, the undersigned, officer of the Chicago, Milwaukee & St. Paul Railway Co. do hereby certify that this is a correct map, in a series of 3 sheets, primary sheets and 167 sheets, supplemented sheets, of said railroad, from survey station 121+33.1 to survey station 48+00 prepared from the records of said company.

Ch. Lodge
Valuation Engineer

W.W.H. Spawny
Assistant to President

Subscribed and sworn to before me this 11th day of December 1971
Edward M. Oakley
Notary Public in and for the
County of Cook,
State of Illinois.

My commission expires April 1, 1974.

RIGHT OF WAY AND TRACK MAP
CHICAGO, MILWAUKEE & ST. PAUL RY. CO.

OPERATED BY THE
CHICAGO, MILWAUKEE & ST. PAUL RY. CO.
COAST DIVISION ENUMCLAW LINE
STATION 121+33.1 TO STATION 89+86.9

SCALE: 1" = 4 MILES JUNE 30, 1912.
OFFICE OF VALUATION ENGINEER
CHICAGO, ILLINOIS.

